

RoHS

HF

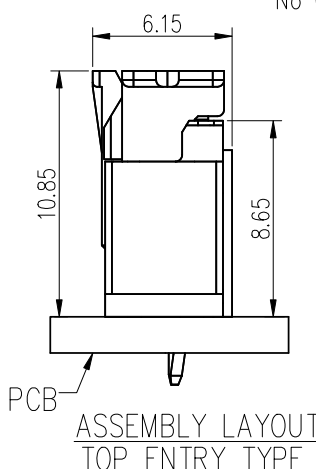
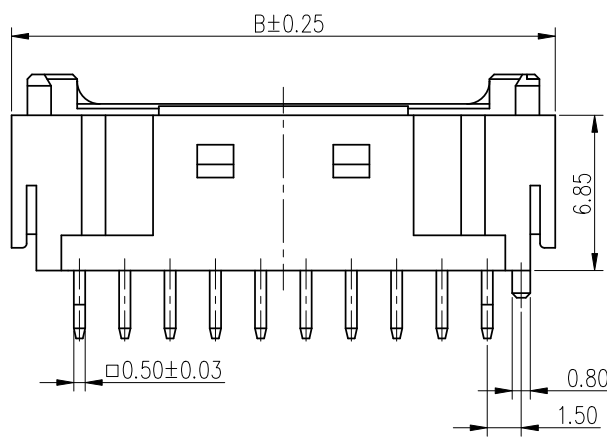
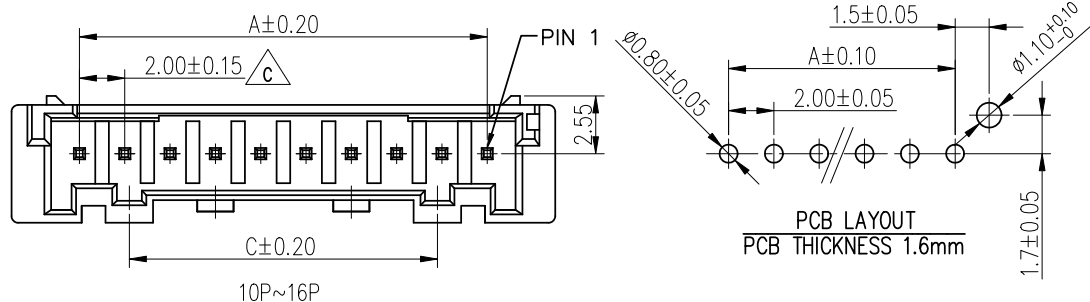

NOTE:  
 1. MATERIAL:  
 1.1. INSULATION: NYLON 6T UL 94V-0  
 1.2. CONTACT=SQ 0.50mm BRASS  
 2. FINISH: TIN/GOLD PLATING  
 3. RoHS & HF COMPLIANCE  
 4. BILL OF PART NO:  
 2015WVBS-XP-XX-XX-HF  
 No OF CIRCUITS: 2~16  
 FINISH:  
 A=MATTE-TIN PLATING  
 B=BRIGHT-TIN PLATING  
 C=GOLD FLASH PLATING  
 5. FOR FINISH, COLOR, AVAILABILITY, DELIVERY & MOQ, CONTACT CKM  
 6. DIMENSIONAL

POS	A	B	C	D
2	—	8.0	—	2.2
3	4.00	10.0	—	2.6
4	6.00	12.0	—	3.0
5	8.00	14.0	—	3.2
6	10.00	16.0	7.00	
7	12.00	18.0		
8	14.00	20.0		
9	16.00	22.0		
10	18.00	24.0		
11	20.00	26.0		
12	22.00	28.0	13.60	
13	24.00	30.0		
14	26.00	32.0		
15	28.00	34.0		
16	30.00	36.0		

COLOR CODE	
BLANK	NATURAL
A	BLACK
B	BROWN
C	RED
D	ORANGE
E	YELLOW
F	GREEN
G	BLUE
H	PURPLE
J	GREY
K	WHITE
M	MILKY YELLOW
Q	BRICK RED
U	MILKY WHITE

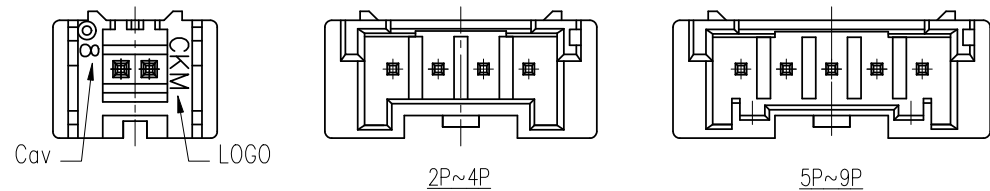

CKM  
2018.01.09  
研發部

TOLERANCE		PART NO.		朝貴電子股份有限公司 CKM ELECTRONICS CO., LTD.		
X. X.X ±0.40	X.XXX ±0.10	2015WVBS-XP-XX-XX-HF				
X.XX ±0.30	Angular ±2°	DRAWING NO.		DESCRIPTION		
UNIT: mm		C-2015WVBS-XP-XX-XX-HF		2.0mm PITCH VERTICAL DIP TYPE CONNECTOR		
DWG TYPE.		APPROVED BY	CHECKED BY	DRAWN BY	PAGE	REV.
Customer Drawing		Angus Chen 2017.12.09	Jimmy Wang 2017.12.09	LZQ 2017.12.09	1 OF 2	C
				SCALE		
				3 : 1		

C	EC-18010708	修正NOTE及修改公差	LZQ	2017.12.09
B		INFORMATION UPGRADE	Jimmy	2017.09.13
REV.	ECN NO	REVISION RECORD	DRAW	DATE

RoHS

HF

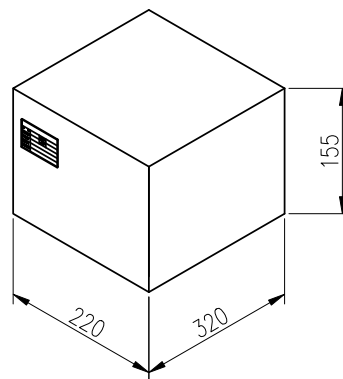
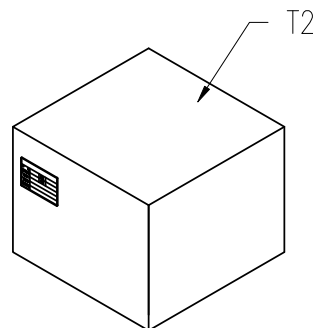
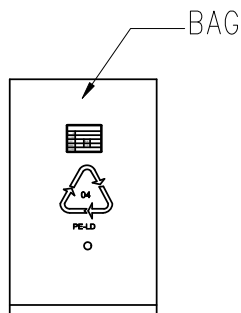
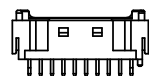

2 Inner BOX

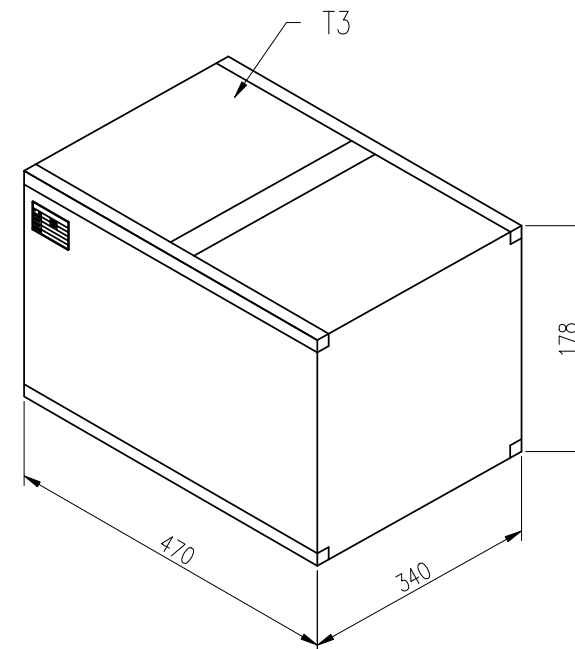

POS	BAG	Inner BOX-T2	Carton-T3	Weight Unit: (Kg)	
	PCS / BAG	PCS / Inner BOX	PCS / Carton	Net Weight	Gross Weight
2	1000	18000	36000	11.52	12.86
3	1000	13000	26000	9.62	10.96
4	1000	9000	18000	9.92	9.30
5	1000	7000	14000	6.16	7.50
6	1000	6000	12000	5.40	6.74
7	1000	6000	12000	6.84	8.18
8	1000	5000	10000	7.68	9.02
9	1000	5000	10000	7.20	8.54
10	1000	4500	9000	7.56	8.90
11	1000	4000	8000	7.12	8.46
12	1000	3500	7000	6.72	8.06
13	1000	3000	6000	6.06	7.40
14	1000	3000	6000	6.36	7.70
15	1000	2500	5000	5.60	6.94
16	1000	2500	5000	5.85	7.19



C	EC-18010708	修正NOTE及修改公差	LZQ	2017.12.09
B		INFORMATION UPGRADE	Jimmy	2017.09.13
REV.	ECN NO	REVISION RECORD	DRAW	DATE

<b>TOLERANCE</b> X. X.X ±0.40 X.XX ±0.30 		X.XXX ±0.10 Angular ±2° UNIT: mm		<b>PART NO.</b> 2015WVBS-XP-XX-XX-HF		朝貴電子股份有限公司 CKM ELECTRONICS CO., LTD.	
<b>DWG TYPE.</b> Customer Drawing				<b>DRAWING NO.</b> C-2015WVBS-XP-XX-XX-HF		<b>DESCRIPTION</b> 2.0mm PITCH VERTICAL DIP TYPE CONNECTOR	
<b>APPROVED BY</b> Angus Chen 2017.12.09		<b>CHECKED BY</b> Jimmy Wang 2017.12.09		<b>DRAWN BY</b> LZQ 2017.12.09		<b>PAGE</b> 2 OF 2	<b>REV.</b> C
						<b>SCALE</b> 3 : 1	