

# PROPOSAL

# RoHS

### CUST INFORMATION.

PART NO. NA	DRAWING NO. NA	REV. NA
----------------	-------------------	------------

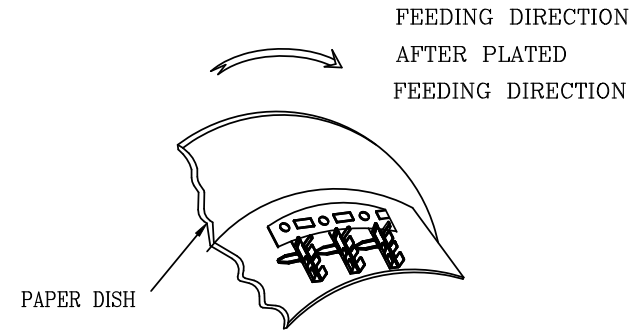
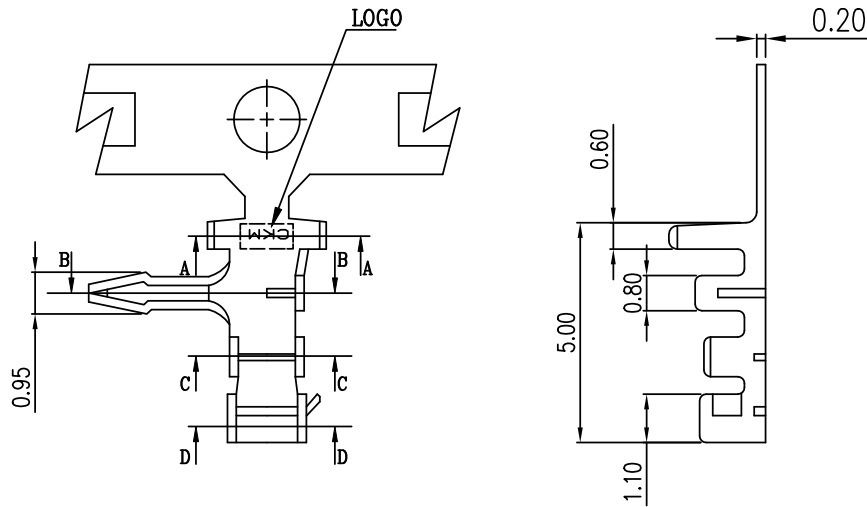

THE PAPER DISH ACCEPTS THE MATERIAL SKETCH MAP

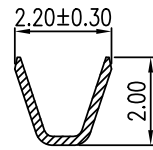

SEC A-A

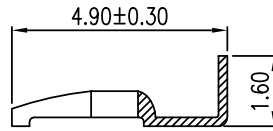

SEC B-B

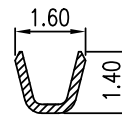

SEC C-C

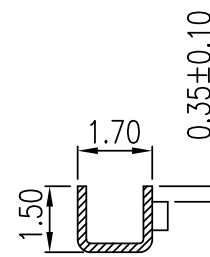

SEC D-D

NOTE:

1. MATERIAL: 0.20mm THICK COPPER ALLOY
2. FINISH: TIN PLATED
3. APPLICABLE WIRES: AWG#30~#24
4. INSULATION O.D.: 0.9~1.3mm.
5. Q'TY REEL: 10000 PCS.
6. BILL OF PART NO:

2002TRX-BX  
 B=BRASS ← 1=PRE-TIN PLATING  
 P=PHOSPHOR BRONZE 2=POST-TIN PLATING

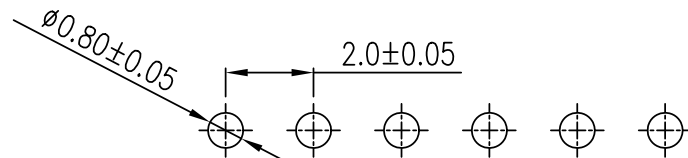

RECOMMENDED PCB LAYOUT  
(PCB THK=1.0 OR 1.6)

<b>TOLERANCE</b>		<b>PART NO.</b>		朝貴電子股份有限公司 CKM ELECTRONICS CO., LTD.	
X. X.X ±0.30	X.XXX ±0.10	2002TRX-BX			
X.XX ±0.20	Angular ±2°	<b>DRAWING NO.</b>		<b>TITLE.</b>	
UNIT: mm DWG TYPE: Customer Drawing		C-20020302/04/12		2.0mm PITCH BOARD-IN CRIMP TERMINAL SOCKET	
<b>APPROVED BY</b>		<b>CHECKED BY</b>		<b>DRAWN BY</b>	
				PAGE 1 OF 1	
				SCALE 6 : 1	
				REV. 1	

1		PROPOSAL DRAWING	Jimmy.W	2016.06.22
REV.	ECN NO	REVISION RECORD	DRAW	DATE