

RoHS

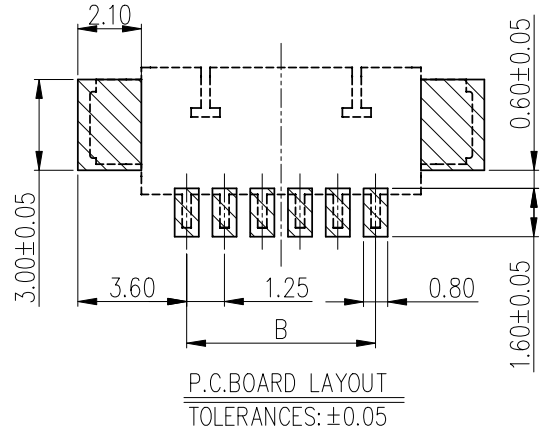

HF

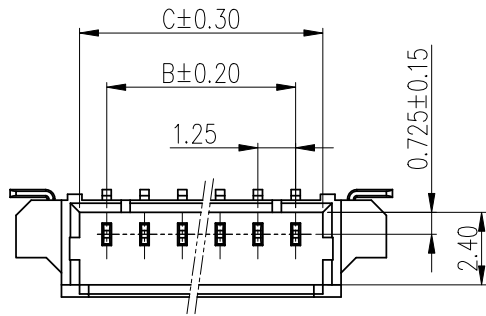

NOTE:

- MATERIAL SPECIFICATION:
 - 1.1 INSULATION: LCP UL 94V-0
 - 1.2 CONTACT: THICK 0.3mm PHOSPHOR BRONZE.
 - 1.3 SOLDER TAB: THICK 0.25mm PHOSPHOR BRONZE.

- FINISH:
 - 2.1 CONTACT: MATTE TIN PLATING
 - 2.2 SOLDER TAB: MATTE TIN PLATED

- RoHS & HF COMPLIANCE
- BILL OF PART NO:

1253WE-XP-AX-HC-HF

→ COLOR: BLANK(NATURAL)
A=BLACK

→ NO. OF CIRCUITS: 2~10

- FOR COLOR, AVAILABILITY, DELIVERY AND MOQ, PLEASE CONTACT CKM.

- DIMENSIONAL

POS	A	B	C	D
2	4.25	3.05	7.25	
3	5.50	2.50	4.30	8.50
4	6.75	3.75	5.55	9.75
5	8.00	5.00	6.80	11.00
6	9.25	6.25	8.05	12.25
7	10.50	7.50	9.30	13.50
8	11.75	8.75	10.55	14.75
9	13.00	10.00	11.80	16.00
10	14.25	11.25	13.05	17.25

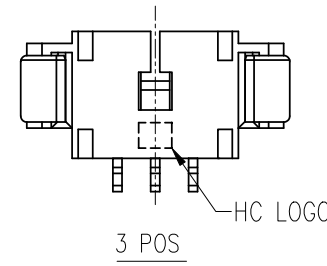
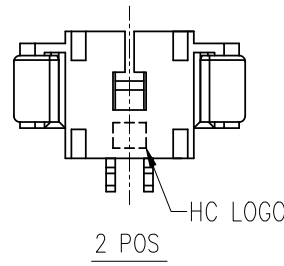
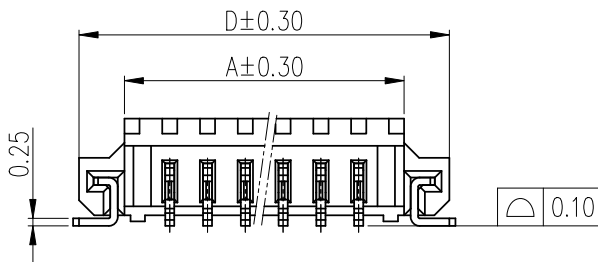
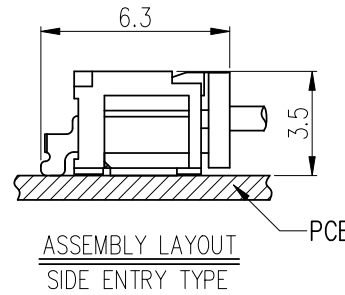
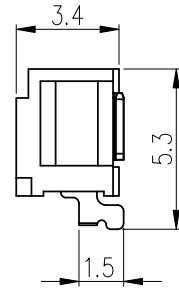
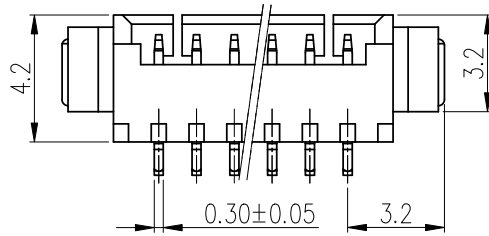

TOLERANCE		PART NO.		朝貴電子股份有限公司 CKM ELECTRONICS CO., LTD.		
X.	X.XXX ±0.10	1253WE-XP-XX-HC-HF				
X.X	±0.30	DRAWING NO.		DESCRIPTION		
X.XX	±0.20	C-1253WE-XP-XX-HC-HF		1.25mm PITCH RIGHT ANGLE SMT TYPE CONNECTOR		
UNIT: mm		APPROVED BY	CHECKED BY	DRAWN BY	PAGE	REV.
DWG TYPE.		Angus.Chen	Jeff.Wen	Rock	1 OF 2	A
Customer Drawing		2018.08.02	2018.08.02	2018.08.02	SCALE	
					4 : 1	

REV.	ECN NO	REVISION RECORD	DRAW	DATE
A		NEW RELEASE	Rock	2018.08.02

RoHS



HF

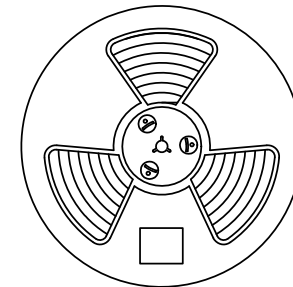
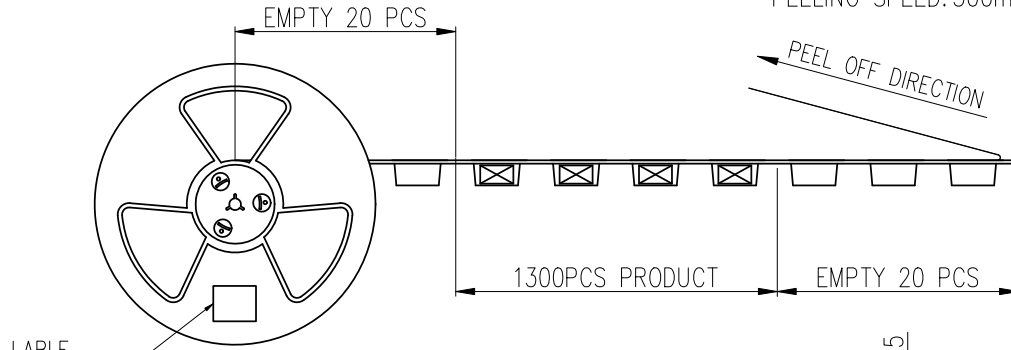
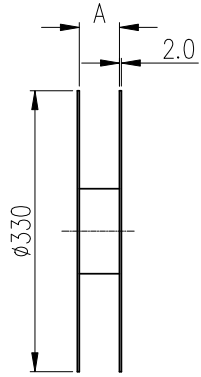

LABLE
STICK TO
THE BACK

PEELING STRENGTH: 10~130GF
PEELING SPEED: 300mm/Min

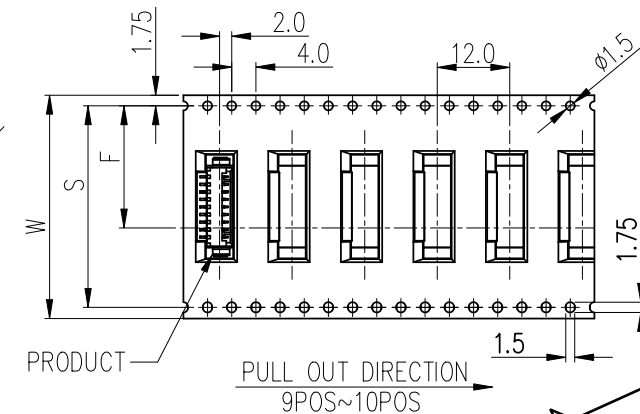
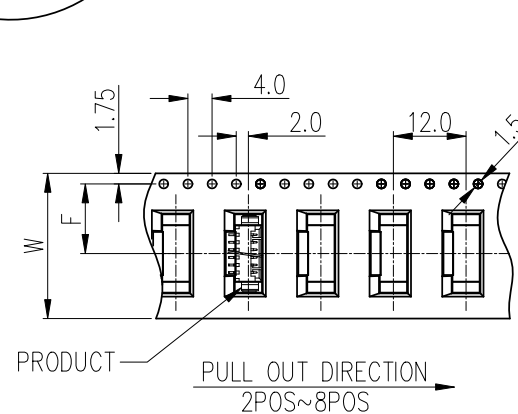
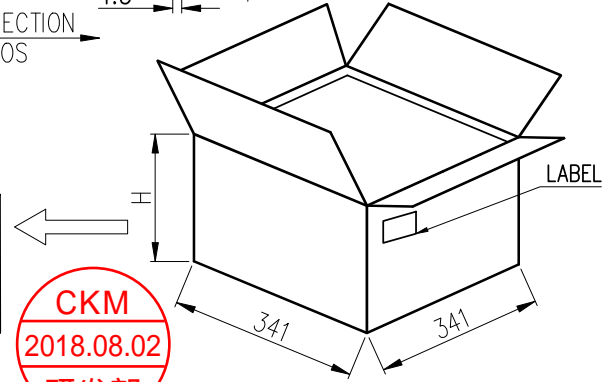
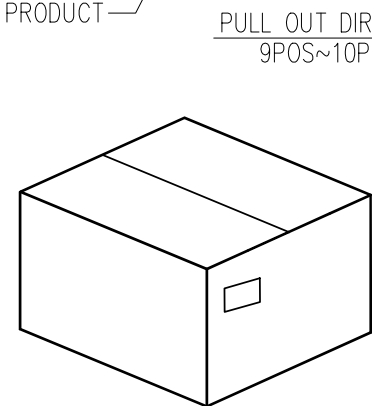

TABLE 1:

POS.	A	W	S	F	H
2~8	24.5	24.0	/	11.5	120
9~10	44.5	44.0	40.4	20.2	180

TABLE 2:

POS	PCS/REEL	PCS/CARTON	NET WEIGHT (KG)	CROSS WEIGHT (KG)
2	1300	3900	0.47	2.60
3	1300	3900	0.56	2.69
4	1300	3900	0.64	2.76
5	1300	3900	0.72	2.85
6	1300	3900	0.80	2.93
7	1300	3900	0.88	3.01
8	1300	3900	0.96	3.09
9	1300	3900	1.05	3.87
10	1300	3900	1.13	3.96



CKM
2018.08.02
研发部

TOLERANCE X. X.XXX ±0.10 X.X ±0.30 X.XX ±0.20 Angular ±2°		PART NO. 1253WE-XP-XX-HC-HF		朝貴電子股份有限公司 CKM ELECTRONICS CO., LTD.	
UNIT: mm DWG TYPE. Customer Drawing		DRAWING NO. C-1253WE-XP-XX-HC-HF		DESCRIPTION 1.25mm PITCH RIGHT ANGLE SMT TYPE PACKING	
APPROVED BY Angus.Chen 2018.08.02		CHECKED BY Jeff.Wen 2018.08.02		DRAWN BY Rock 2018.08.02	
REV. A		SCALE 4:1		PAGE 2 OF 2 REV. A	

A		NEW RELEASE	Rock	2018.08.02
REV.	ECN NO	REVISION RECORD	DRAW	DATE