

RoHS

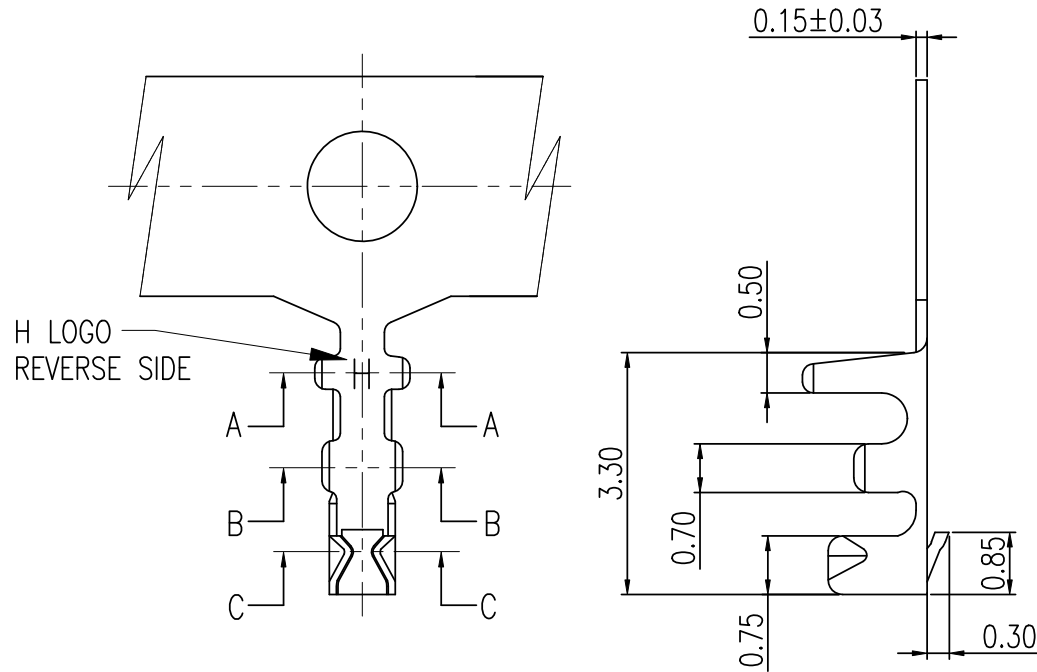

NOTES:

1. MATERIAL: 0.15mm THICK HIGH CONDUCTIVITY COPPER ALLOY
2. FINISH: POST-BRIGHT TIN PLATING OR GOLD FLASH.
3. APPLICABLE WIRES: AWG#28.
4. INSULATOR O.D.: 1.00mm MAX.
5. RoHS COMPLIANT.
6. FOR AVAILABILITY, DELIVERY & MOQ, CONTACT CKM.

PART NO: 1251TOH-XX

FINISH: B2=POST-BRIGHT TIN
C=POST-GOLD FLASH(OVER ALL)

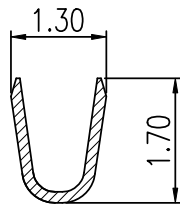

SEC A-A

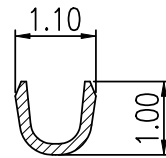

SEC B-B

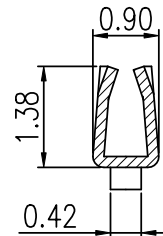

SEC C-C



C	EC-22020049	UPGRADE DRAWING	Rock	2022.02.16
B		UPGRADE DRAWING	Rock	2018.08.29
A		NEW RELEASE	Rock	2018.08.01
REV.	ECN NO	REVISION RECORD	DRAW	DATE

TOLERANCE	
X.	X.XXX ±0.10
X.X ±0.30	
X.XX ±0.20	Angular ±2°
UNIT: mm	
DWG TYPE: Customer Drawing	

PART NO. 1251TOH-XX		朝貴電子股份有限公司 CKM ELECTRONICS CO., LTD.		
DRAWING NO. C-1251TOH-XX		DESCRIPTION 1.25mm PITCH CRIMP TERMINAL		
APPROVED BY Ivan.Su 2022.02.16	CHECKED BY Sun.Lee 2022.02.16	DRAWN BY Rock 2022.02.16	PAGE 1 OF 2 SCALE 10 : 1	REV. C

RoHS



1

2

3

4

5

6

A

A

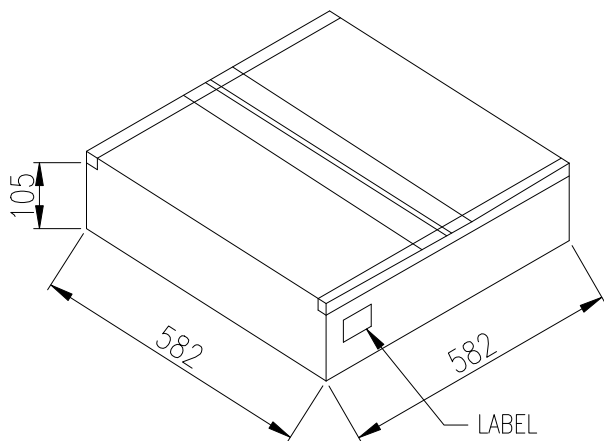
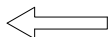
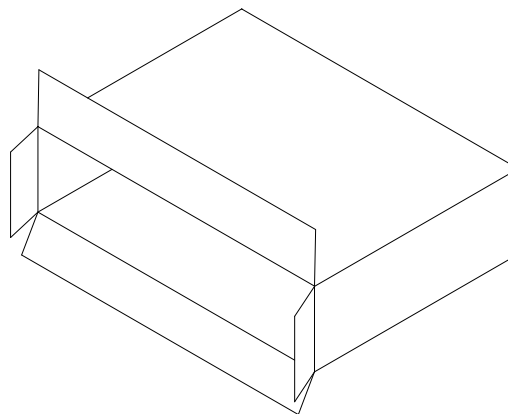
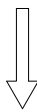
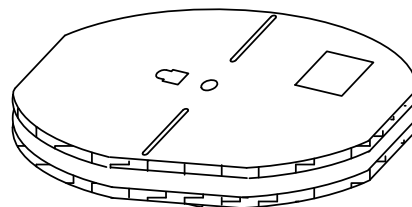
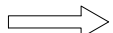
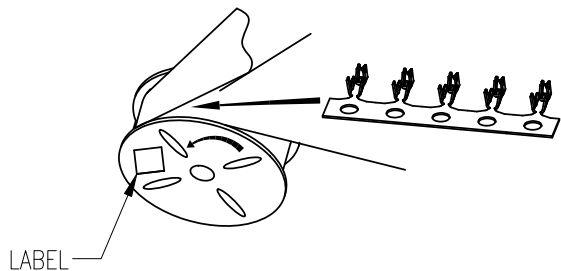

PART NO.	PCS/REEL	PCS/CARTON	NET WEIGHT (KG)	CROSS WEIGHT (KG)
1251TOH-XX	20K	60K	1.68	4.02

B

B

C

C

D

D

C	EC-22020049	UPGRADE DRAWING	Rock	2022.02.16
B		UPGRADE DRAWING	Rock	2018.08.29
A		NEW RELEASE	Rock	2018.08.01
REV.	ECN NO	REVISION RECORD	DRAW	DATE

TOLERANCE		PART NO.	朝貴電子股份有限公司 CKM ELECTRONICS CO., LTD.		
X.	X.XXX ±0.10	1251TOH-XX	DESCRIPTION 1.25mm PITCH CRIMP TERMINAL PACKING		
X.X ±0.30		DRAWING NO. C-1251TOH-XX			
X.XX ±0.20	Angular ±2°		APPROVED BY Ivan.Su 2022.02.16	CHECKED BY Sun.Lee 2022.02.16	DRAWN BY Rock 2022.02.16
UNIT: mm DWG TYPE. Customer Drawing			PAGE 2 OF 2	SCALE 1:1	REV. C

1

2

3

4

5

6

QMI-P12-05-01