

RoHS

HF

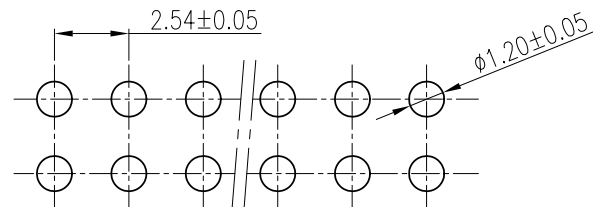
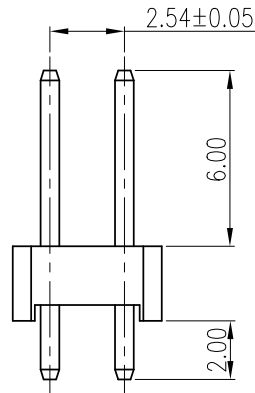
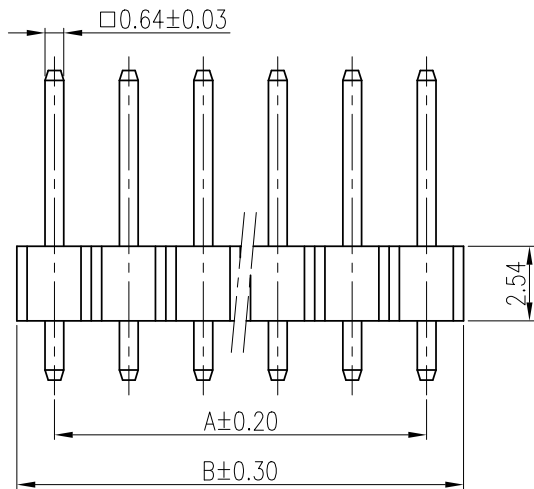
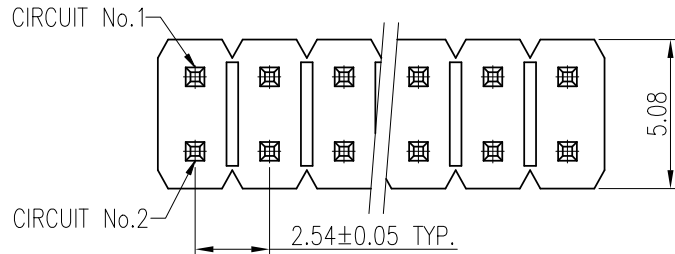

RECOMMENDED PCB LAYOUT (TOP VIEW)
 (ALL TOLERANCES ARE ±0.05)
 PCB BOARD THK 1.0~1.6mm

NOTE:

1. MATERIAL:

1.1 INSULATOR: LCP UL 94V-0 (BLACK)

1.2 CONTACT: SQ 0.64mm BRASS

2. FINISH: GOLD FLASH PLATING

3. RoHS & HALOGEN FREE COMPLIANCE

4. BILL OF PART NO:

2542WV-2BGxXP-CA-LC-RPC-HF

DUAL ROW ← NO. OF CIRCUITS: 2~20

5. FOR AVAILABILITY, DELIVERY & MOQ, CONTACT CKM

6. DIMENSIONAL

| POS | A | B | POS | A | B |
|------|-------|-------|------|-------|-------|
| 2x2 | 2.54 | 5.08 | 2x12 | 27.94 | 30.48 |
| 2x3 | 5.08 | 7.62 | 2x13 | 30.48 | 33.02 |
| 2x4 | 7.62 | 10.16 | 2x14 | 33.02 | 35.56 |
| 2x5 | 10.16 | 12.70 | 2x15 | 35.56 | 38.10 |
| 2x6 | 12.70 | 15.24 | 2x16 | 38.10 | 40.64 |
| 2x7 | 15.24 | 17.78 | 2x17 | 40.64 | 43.18 |
| 2x8 | 17.78 | 20.32 | 2x18 | 43.18 | 45.72 |
| 2x9 | 20.32 | 22.86 | 2x19 | 45.72 | 48.26 |
| 2x10 | 22.86 | 25.40 | 2x20 | 48.26 | 50.80 |
| 2x11 | 25.40 | 27.94 | | | |



TOLERANCE

| | |
|------------|-------------|
| X. | X.XXX ±0.10 |
| X.X ±0.30 | |
| X.XX ±0.20 | Angular ±2° |

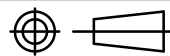

UNIT:
mm

DWG TYPE.
Customer Drawing

PART NO.
2542WV-2BGxXP-CA-LC-RPC-HF

DRAWING NO.
C-2542WV-2BGxXP-CA-LC-RPC-HF

APPROVED BY
Ivan.su
2022.08.01

CHECKED BY
Sun.lee
2022.08.01



朝貴電子股份有限公司
CKM ELECTRONICS CO., LTD.

DESCRIPTION
2.54mm PITCH VERTICAL DIP TYPE CONNECTOR

DRAWN BY
Angel.tong
2022.08.01

PAGE
1 OF 1
SCALE
4 : 1

REV.
B

| | | | | |
|------|-------------|-----------------|------------|------------|
| B | EC-22081294 | CHANGE DRAWING | Angel.tong | 2022.08.01 |
| A | | NEW RELEASE | Jimmy Wang | 2020.05.29 |
| REV. | ECN NO | REVISION RECORD | DRAW | DATE |

RoHS

HF

PEELING STRENGTH:10~130GF
PEELING SPEED:300mm/Min

A

B

C

D

A

B

C

D

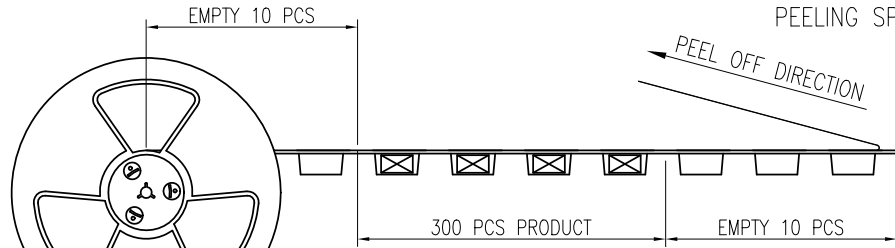

CKM
2022.08.03
研发部

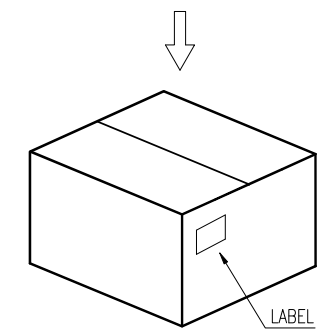
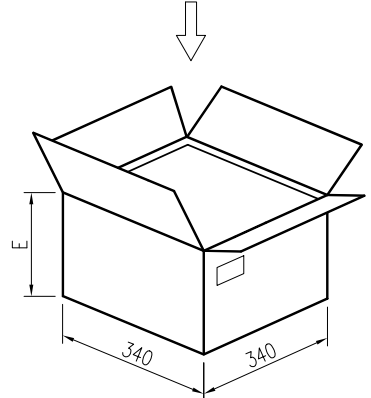
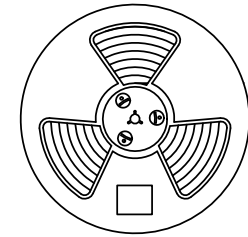

| POS | A | B | C | D | E | PCS/REEL | PCS/CARTON |
|------|------|------|------|------|-----|----------|------------|
| 2x2 | 24.0 | -- | 11.5 | 30.0 | 120 | 300 | 900 |
| 2x3 | | | | | | | |
| 2x4 | | | | | | | |
| 2x5 | | | | | | | |
| 2x6 | 32.0 | 28.4 | 14.2 | 38.0 | 145 | | |
| 2x7 | | | | | | | |
| 2x8 | | | | | | | |
| 2x9 | 44.0 | 40.4 | 20.2 | 50.0 | 180 | | |
| 2x10 | | | | | | | |
| 2x11 | | | | | | | |
| 2x12 | | | | | | | |
| 2x13 | 56.0 | 52.4 | 26.2 | 62.0 | 220 | | |
| 2x14 | | | | | | | |
| 2x15 | | | | | | | |
| 2x16 | | | | | | | |
| 2x17 | | | | | | | |
| 2x18 | 72.0 | 68.4 | 34.2 | 78.0 | 280 | | |
| 2x19 | | | | | | | |
| 2x20 | | | | | | | |

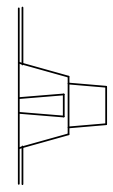
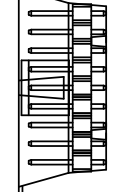
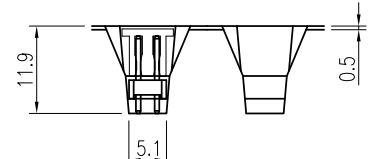
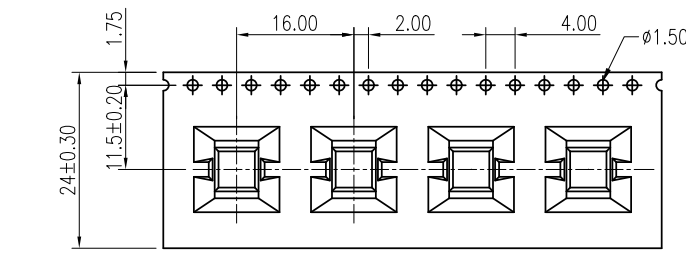
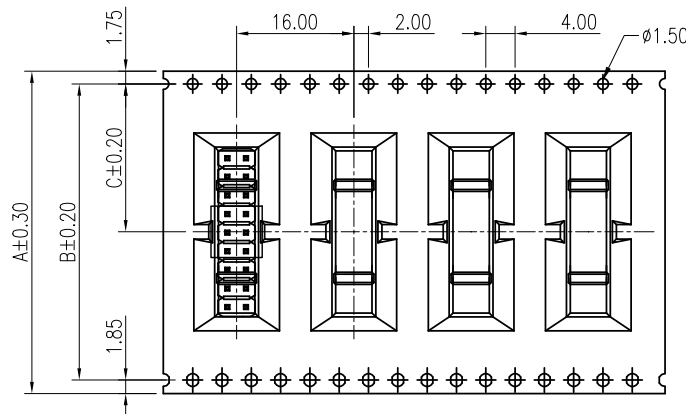

| | | | | | |
|------------------|-------------|------------------------------|-------------------|--|--------------|
| TOLERANCE | | PART NO. | | 朝貴電子股份有限公司 CKM ELECTRONICS CO., LTD. | |
| X. X.XXX ±0.10 | X.X ±0.30 | 2542WV-2BGxXP-CA-LC-RPC-HF | | | |
| X.XX ±0.20 | Angular ±2° | DRAWING NO. | | DESCRIPTION | |
| | | C-2542WV-2BGxXP-CA-LC-RPC-HF | | 2.54mm PITCH VERTICAL DIP TYPE CONNECTOR | |
| UNIT: | | APPROVED BY | CHECKED BY | DRAWN BY | PAGE |
| mm | | Ivan.su | Sun.lee | Angel.tong | 2 OF 2 |
| DWG TYPE. | | 2022.08.01 | 2022.08.01 | 2022.08.01 | REV. |
| Customer Drawing | | | | | B |
| | | | | | SCALE |
| | | | | | 4 : 1 |

| | | | | |
|------|-------------|-----------------|------------|------------|
| B | EC-22081294 | CHANGE DRAWING | Angel.tong | 2022.08.01 |
| A | | NEW RELEASE | Jimmy Wang | 2020.05.29 |
| REV. | ECN NO | REVISION RECORD | DRAW | DATE |