

RoHS

CUST INFORMATION.

PART NO. NA	DRAWING NO. NA	REV. NA
----------------	-------------------	------------

NOTES:

1. MATERIALS:

- 1.1 HOUSING: THERMOPLASTIC, UL94 V-0,
- 1.2 INSERT: THERMOPLASTIC, UL94 V-0,
- 1.3 TERMINAL: Ø0.45MM PHOSPHOR BRONZE
GOLD PLATING OVER NICKEL.

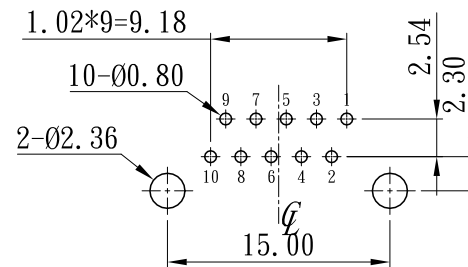
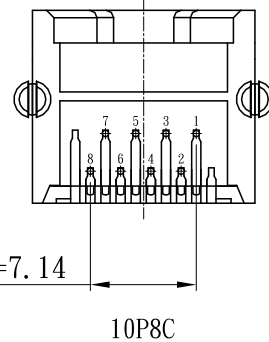
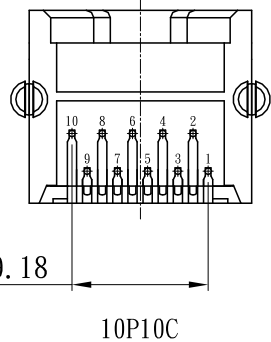
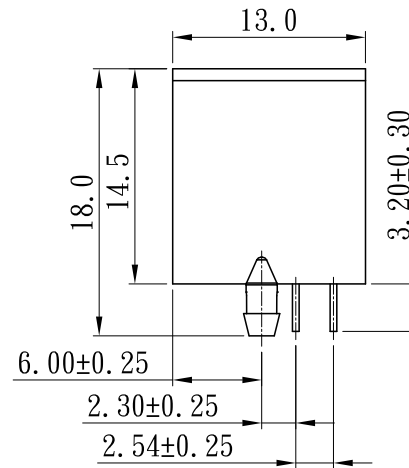
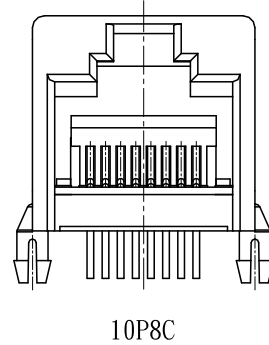
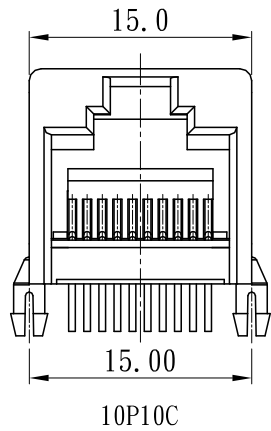

RECOMMENDED PCB LAYOUT(TOP VIEW)
(ALL TOLERANCES ARE ±0.05)
TOP VIEW (COMPONENT SIDE)
10P10C

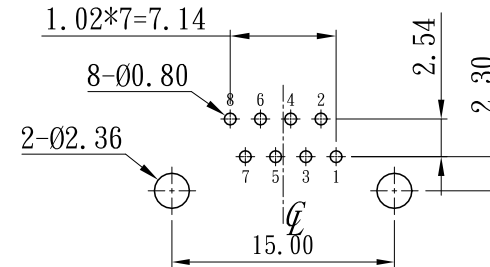

RECOMMENDED PCB LAYOUT(TOP VIEW)
(ALL TOLERANCES ARE ±0.05)
TOP VIEW (COMPONENT SIDE)
10P8C

A	NEW RELEASE	Flyer	2023/06/26
REV.	ECN NO	REVISION RECORD	DRAW DATE

TOLERANCE X. X.XXX ±0.10 X.X ±0.30 X.XX ±0.20 Angular ±2°		PART NO. 552100-0X0X-1000-XX		朝貴電子股份有限公司 CKM ELECTRONICS CO., LTD.	
		DRAWING NO. C-552100-0X0X-1000-XX		TITLE. RJ45 5521 1*1 SERIES 10P10C/10P8C 1*1 W/O LED W/ EARS TYPE	
DWG TYPE. Customer Drawing		APPROVED BY Ivan 2023/06/26	CHECKED BY Flyer 2023/06/26	DRAWN BY Flyer 2023/06/26	PAGE 1 OF 1 SCALE 2 : 1
					REV. A