

RoHS

CKM
2023.08.21
研发部

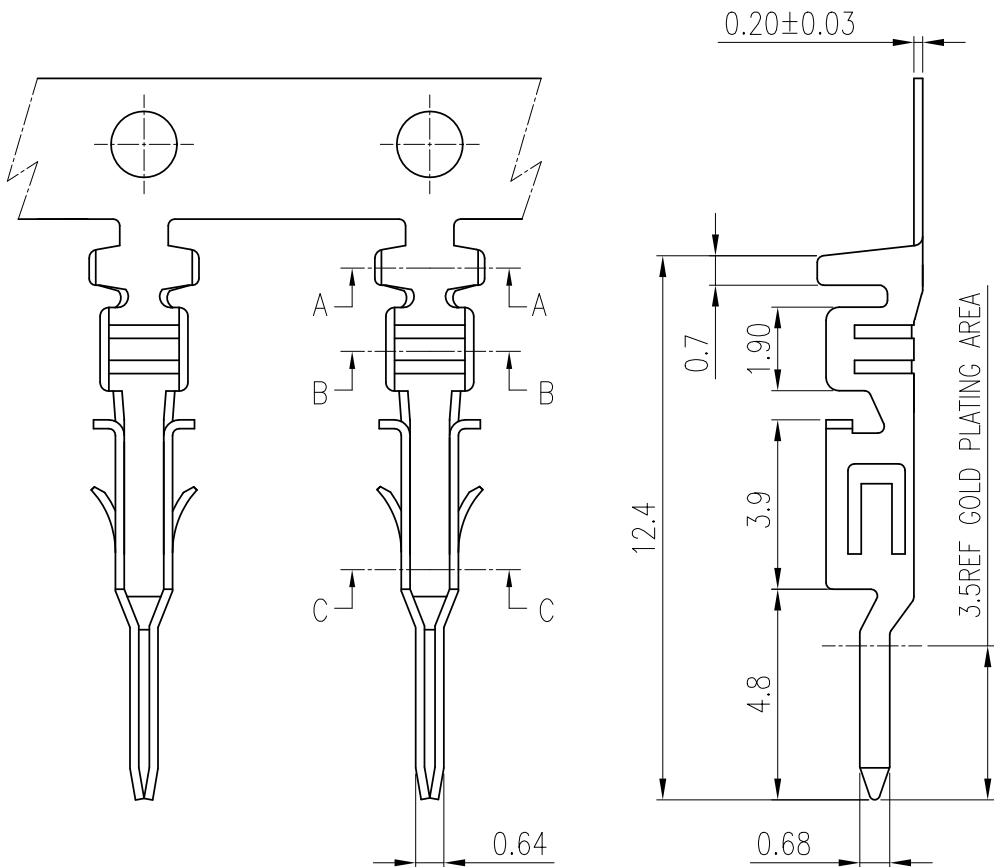

- NOTES:
1. MATERIAL: 0.20mm THICK PHOSPHOR BRONZE
 2. FINISH: TIN OR GOLD PLATING;
NICKEL UNDER PLATING OVERALL
 3. APPLICABLE WIRES: AWG #24~#20
 4. INSULATION O.D.: 1.85mm Max.
 5. RoHS COMPLIANT
 6. BILL OF PART NO:
3001TM2P-XX
 - FINISH: B1=PRE-BRIGHT TIN PLATING
 - C=GOLD FLASH PLATING(CONTACT AREA)
 7. TERMINAL Q'ty/REEL:10,000 PCS.
 8. FOR FINISH AVAILABILITY, DELIVERY & MOQ, CONTACT CKM

TOLERANCE		PART NO.		朝貴電子股份有限公司 CKM ELECTRONICS CO., LTD.	
X. X.XX ±0.30	X.XXX ±0.10	3001TM2P-XX			
X.X ±0.30 X.XX ±0.20 Angular ±2°		DRAWING NO.		DESCRIPTION	
		C-30010301-XX		3.0mm PITCH CRIMP TERMINAL (MALE)	
UNIT: mm		APPROVED BY	CHECKED BY	DRAWN BY	PAGE
DWG TYPE. Customer Drawing		Angus.Chen 2023.08.17	Sun.Lee 2023.08.17	Rock 2023.08.17	1 OF 2
					SCALE 6 : 1
					REV. C

C	EC-23081652	UPGRADE DRAWING	Rock	2023.08.17
B	EC-22031143	ADD PACKAGE	Rock	2022.03.08
REV.	ECN NO	REVISION RECORD	DRAW	DATE

RoHS

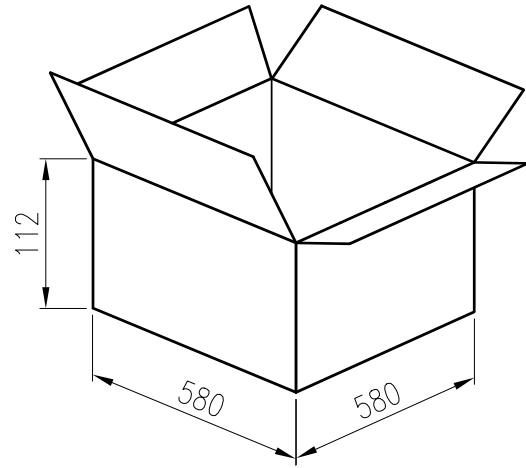
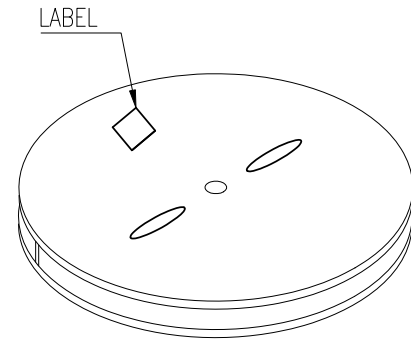
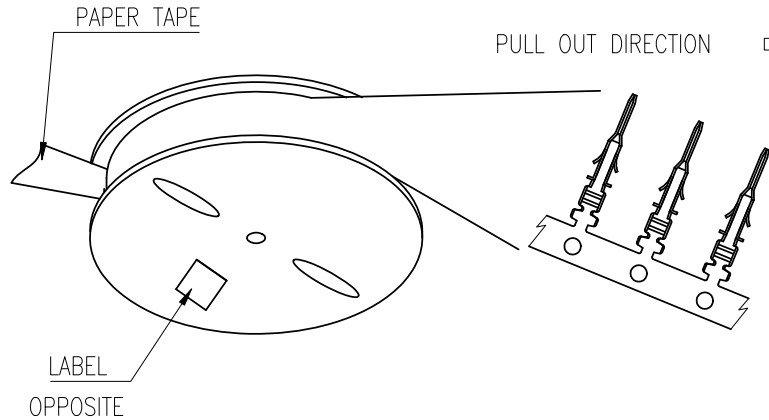
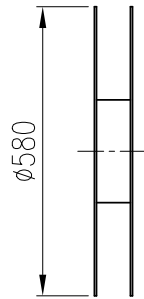

TRAY/PCS	CARTON/PCS
10000 PCS	30000 PCS

TOLERANCE X. X.XXX ±0.10 X.X ±0.30 X.XX ±0.20 Angular ±2°		PART NO. 3001TM2P-XX		朝貴電子股份有限公司 CKM ELECTRONICS CO., LTD.	
		DRAWING NO. C-30010301-XX		DESCRIPTION 3.0mm PITCH CRIMP TERMINAL (MALE)	
DWG TYPE. Customer Drawing		APPROVED BY Angus.Chen 2023.08.17	CHECKED BY Sun.Lee 2023.08.17	DRAWN BY Rock 2023.08.17	PAGE 2 OF 2 SCALE 6 : 1
					REV. C

C	EC-23081652	UPGRADE DRAWING	Rock	2023.08.17
B	EC-22031143	ADD PACKAGE	Rock	2022.03.08
REV.	ECN NO	REVISION RECORD	DRAW	DATE