

RoHS

HF

CKM  
2023.07.31  
研发部

NOTE:

1. MATERIAL:

1.1 INSULATION: LCP, UL94V-0

1.2 CONTACT: SQ 0.64mm BRASS OR HIGH CONDUCTIVITY COPPER ALLOY

1.3 BOARDLOCK: 0.40mm THICKNESS BRASS

2. FINISH:

2.1 CONTACT: MATTE-TIN/GOLD PLATED

2.2 BOARDLOCK: MATTE-TIN PLATED

3. RoHS & HALOGEN FREE COMPLIANCE

4. BILL OF PART NO:

3001WR-2xXP-XX-XX-XX-HF

No. OF CIRCUITS: 1~12

FINISH:

A=MATTE-TIN PLATING

C=GOLD FLASH PLATING

C4=MATTE-TIN&15u" GOLD PLATING

C7=MATTE-TIN&30u" GOLD PLATING

COLOR:

BLANK=NATURAL

A=BLACK

CONTACT MATERIAL:

B=BRASS

HC=HIGH CONDUCTIVITY COPPER ALLOY

(W/ HC MARK ON INSULATOR)

PACKAGE

TP: TAPE&REEL

PP: TRAY

BOARDLOCK(DIM D)/TAIL(DIM E)

0:1.80 / 2.10

1:1.80 / 3.20

3:2.50 / 2.10

4:2.50 / 3.20

5:2.95 / 2.10

6:2.95 / 3.20

5. TO AVOID INTERFERENCE BETWEEN RECEPTACLE AND PCB, HEADER MUST BE PLACED WITHIN 10.16 MAX. FROM EDGE OF PCB, AS SHOWN IN LOCATION DETAIL.

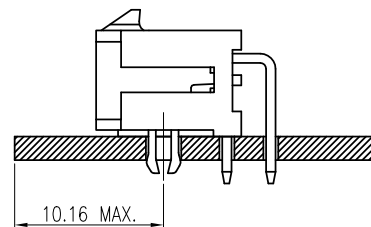
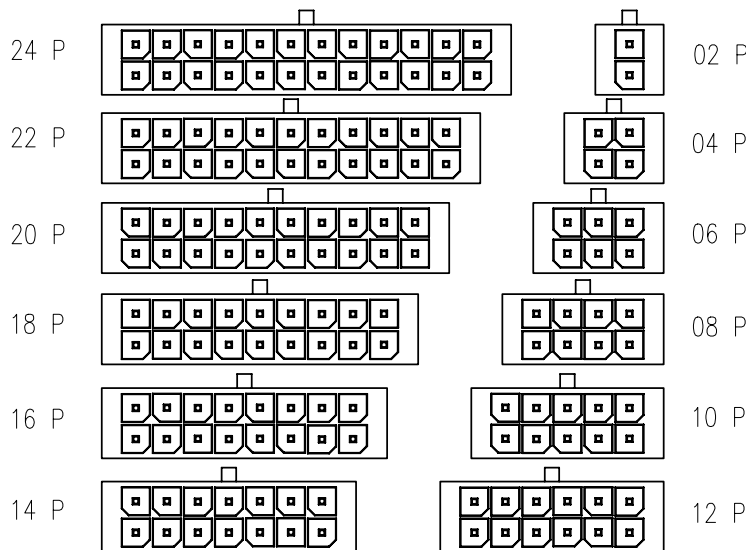
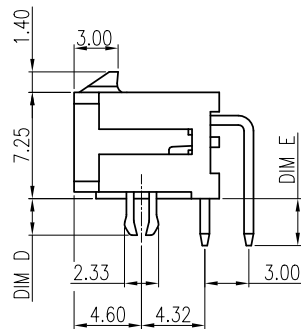
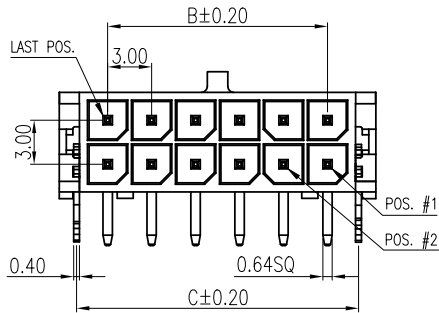
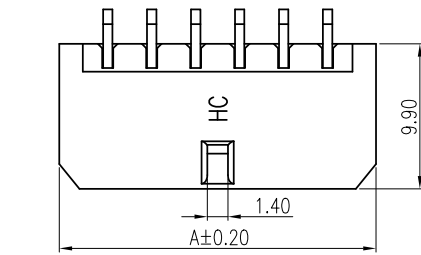

LOCATION DETAIL

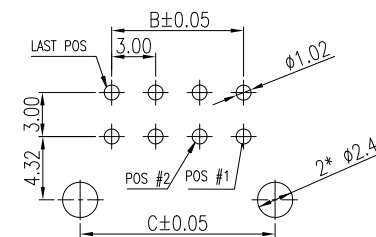

RECOMMENDED PCB LAYOUT (TOP VIEW)  
(ALL TOLERANCES ARE ±0.05)

POS	A	B	C
2	6.60	--	4.30
4	9.60	3.00	7.30
6	12.60	6.00	10.30
8	15.60	9.00	13.30
10	18.60	12.00	16.30
12	21.60	15.00	19.30
14	24.60	18.00	22.30
16	27.60	21.00	25.30
18	30.60	24.00	28.30
20	33.60	27.00	31.30
22	36.60	30.00	34.30
24	39.60	33.00	37.30

TOLERANCE		PART NO.		朝貴電子股份有限公司 CKM ELECTRONICS CO., LTD.	
X.	X.XXX ±0.10	3001WR-2xXP-XX-XX-XX-HF		DESCRIPTION 3.0mm PITCH RIGHT ANGLE DIP TYPE CONNECTOR	
X.X ±0.30		DRAWING NO. C-3001WR-2xXP-XX-XX-XX-HF			
X.XX ±0.20	Angular ±2°	APPROVED BY Angus Chen 2023.07.28	CHECKED BY Sun.Lee 2023.07.28	DRAWN BY Rock 2023.07.28	PAGE 1 OF 3
UNIT: mm		DWG TYPE. Customer Drawing		SCALE 2 : 1	REV. B

REV.	ECN NO	REVISION RECORD	DRAW	DATE
B	EC-23070151	UPGRADE DRAWING	Rock	2023.07.28
A		NEW RELEASE	Rock	2021.02.05

1 RoHS

2 (HF)

3 426(L)\*262.5(W)\*10(H)

4 426(L)\*262.5(W)\*14(H)



TRAY

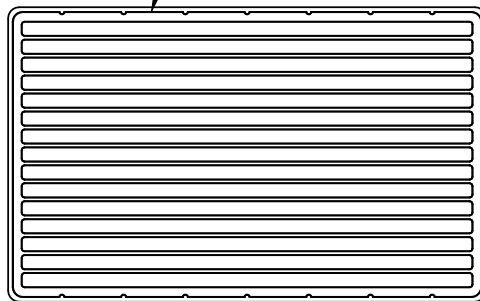

COVER

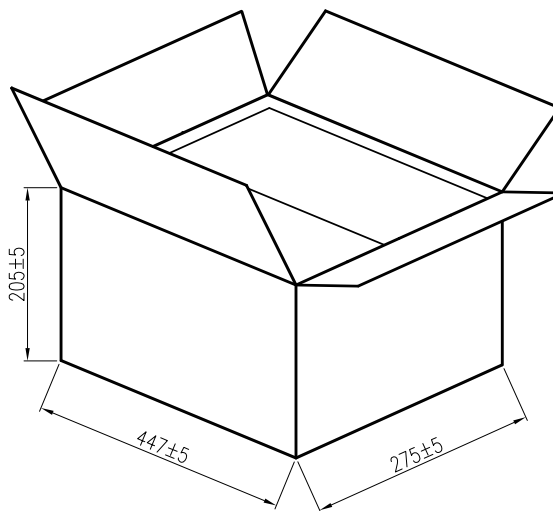
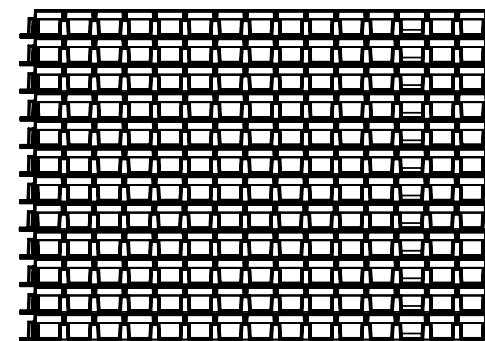
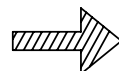

(12 TRAYS IN CARTON)



POS	PCS/TRAY	PCS/CARTON
02	900	10800
04	615	7380
06	465	5580
08	375	4500
10	315	3780
12	270	3240
14	240	2880
16	210	2520
18	180	2160
20	165	1980
22	150	1800
24	150	1800

CKM  
2023.07.31  
研发部

<b>TOLERANCE</b>		<b>PART NO.</b>		朝貴電子股份有限公司 CKM ELECTRONICS CO., LTD.	
X. X.XXX ±0.10	Angular ±2°	3001WR-2xXP-XX-XX-XX-HF			
X.X ±0.30		<b>DRAWING NO.</b>		<b>DESCRIPTION</b>	
X.XX ±0.20		C-3001WR-2xXP-XX-XX-XX-HF		3.0mm PITCH RIGHT ANGLE DIP TYPE CONNECTOR	
<b>UNIT:</b> mm		<b>APPROVED BY</b>	<b>CHECKED BY</b>	<b>DRAWN BY</b>	<b>PAGE</b>
		Angus Chen 2023.07.28	Sun.Lee 2023.07.28	Rock 2023.07.28	<b>2 OF 3</b>
<b>DWG TYPE.</b>				<b>SCALE</b>	<b>REV.</b>
Customer Drawing				2:1	B

B	EC-23070151	UPGRADE DRAWING	Rock	2023.07.28
A		NEW RELEASE	Rock	2021.02.05
REV.	ECN NO	REVISION RECORD	DRAW	DATE

RoHS

HF

A

B

C

D

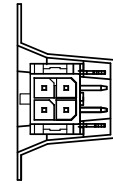
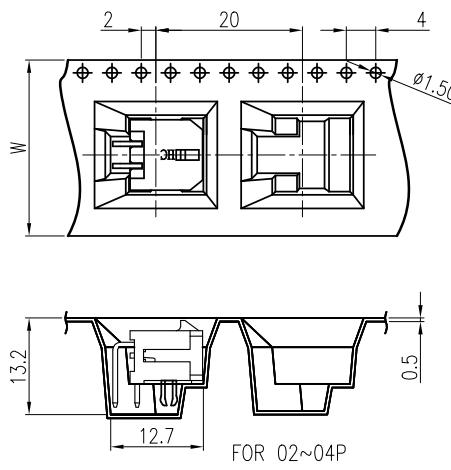
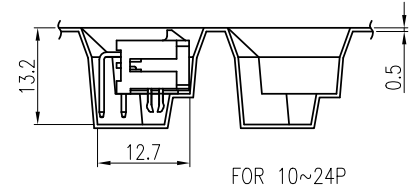
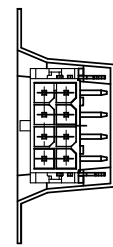
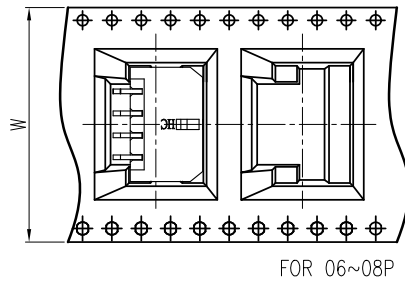
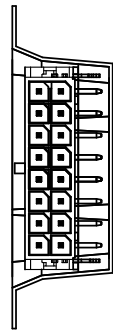
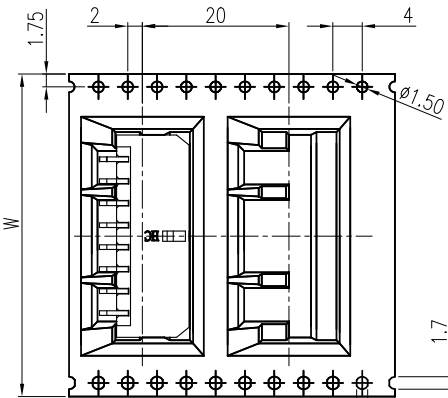

PULL OUT DIRECTION FROM REEL →

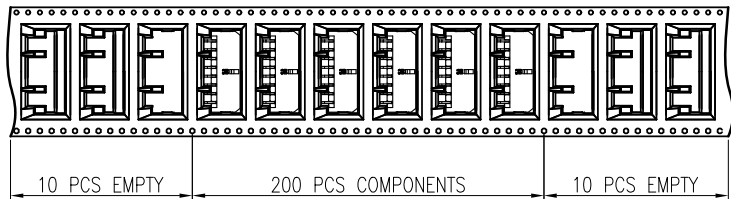

PULL OUT DIRECTION →

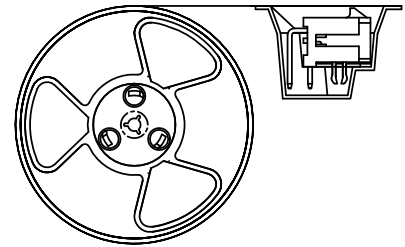

CKM  
2023.07.31  
研发部

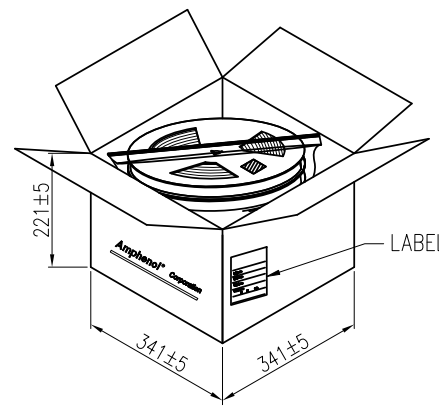
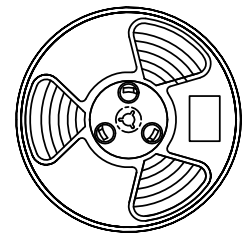
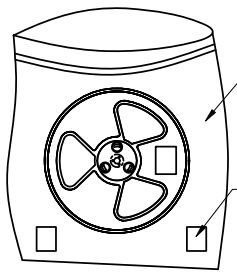

POS	W	PCS/REEL	PCS/CARTON
02	24.0	200	1200
04	24.0	200	1200
06	32.0	200	1000
08	32.0	200	1000
10	44.0	200	800
12	44.0	200	800
14	44.0	200	800
16	44.0	200	800
18	44.0	200	800
20	56.0	200	600
22	56.0	200	600
24	56.0	200	600

<b>TOLERANCE</b> X. X.XXX ±0.10 X.X ±0.30 X.XX ±0.20 Angular ±2°		<b>PART NO.</b> 3001WR-2xXP-XX-XX-XX-HF		朝貴電子股份有限公司 CKM ELECTRONICS CO., LTD.	
		<b>DRAWING NO.</b> C-3001WR-2xXP-XX-XX-XX-HF		<b>DESCRIPTION</b> 3.0mm PITCH RIGHT ANGLE DIP TYPE CONNECTOR	
<b>UNIT:</b> mm		<b>APPROVED BY</b> Angus Chen 2023.07.28	<b>CHECKED BY</b> Sun.Lee 2023.07.28	<b>DRAWN BY</b> Rock 2023.07.28	<b>PAGE</b> 3 OF 3 <b>SCALE</b> 2:1
<b>DWG TYPE.</b> Customer Drawing				<b>REV.</b> B	

B	EC-23070151	UPGRADE DRAWING	Rock	2023.07.28
A		NEW RELEASE	Rock	2021.02.05
REV.	ECN NO	REVISION RECORD	DRAW	DATE